



## Public Safety and National Security Events and Activities

The Esri User Conference (Esri UC) has many presentations and events with hundreds of topics covered. To help you find your way to the public safety and national security sessions and events, we have prepared a more focused agenda.

### Esri National Security and Public Safety Summit

June 25–28, 2016      Hilton San Diego Bayfront

#### One Platform, Many Missions

The Esri National Security and Public Safety Summit is the world's largest geographic information system (GIS) event dedicated to homeland/national security, public safety, and defense. It is attended each year by professionals from around the world, including executives, analysts, intelligence personnel, and frontline staff, to discover how Esri software, services, and partner agencies are improving mission workflows. The Esri National Security and Public Safety Summit will give you unique access to stakeholders like you, who are charged with ensuring a safe community. Experts from around the world will showcase the latest innovations and best practices. Whether you work in defense, national security, intelligence, law enforcement, emergency management, or public safety, you'll see how geospatial technology enables true situational awareness and comprehensive understanding in even the most dire circumstances.

### National Security and Public Safety Social

Sunday, June 26, 5:00 PM–7:00 PM

Hilton San Diego Bayfront, Promenade Patio

Leading-edge GIS users in the public safety, defense, homeland/national security, intelligence, emergency management, health, and law enforcement communities will gather to network and socialize before the weeklong conference.

### Esri Pavilion: Government Neighborhood—Public Safety Community

Tuesday, June 28      9:00 AM–6:00 PM

Wednesday, June 29      9:00 AM–6:00 PM

Thursday, June 30      9:00 AM–1:30 PM

SDCC, Exhibit Hall B1, Ground Level

The Public Safety and National Security Neighborhood will focus on geospatial solutions for emergency management, law enforcement, fire/rescue services, national security, and emergency call-taking and dispatch. Esri is transforming how organizations solve problems and make informed decisions, leading to safer communities worldwide.

Meet your peers and learn how they are implementing the ArcGIS platform in their many missions, anywhere, any time, on any device. Representatives from Esri's Public Safety and Disaster Response teams will be on hand to advise attendees on how to leverage the power of the ArcGIS platform to create a safer community by addressing the challenges facing today's first responders. Solutions and architecture staff will be available to discuss the latest templates, applications, and workflows that have been developed in response to emerging trends in public safety, and training staff will discuss recently developed instructional programs designed specifically for the public safety professional.

Check out the Operations Platform for Safety/Security (OPS) Center Theater inside our neighborhood. OPS Center presentations will illustrate Esri's vision of how web GIS enables agencies to create safer communities by improving their ability to respond to public safety and national security threats.



# Government Neighborhood—Public Safety Community Layout

June 28–30—SDCC, Exhibit Hall B1

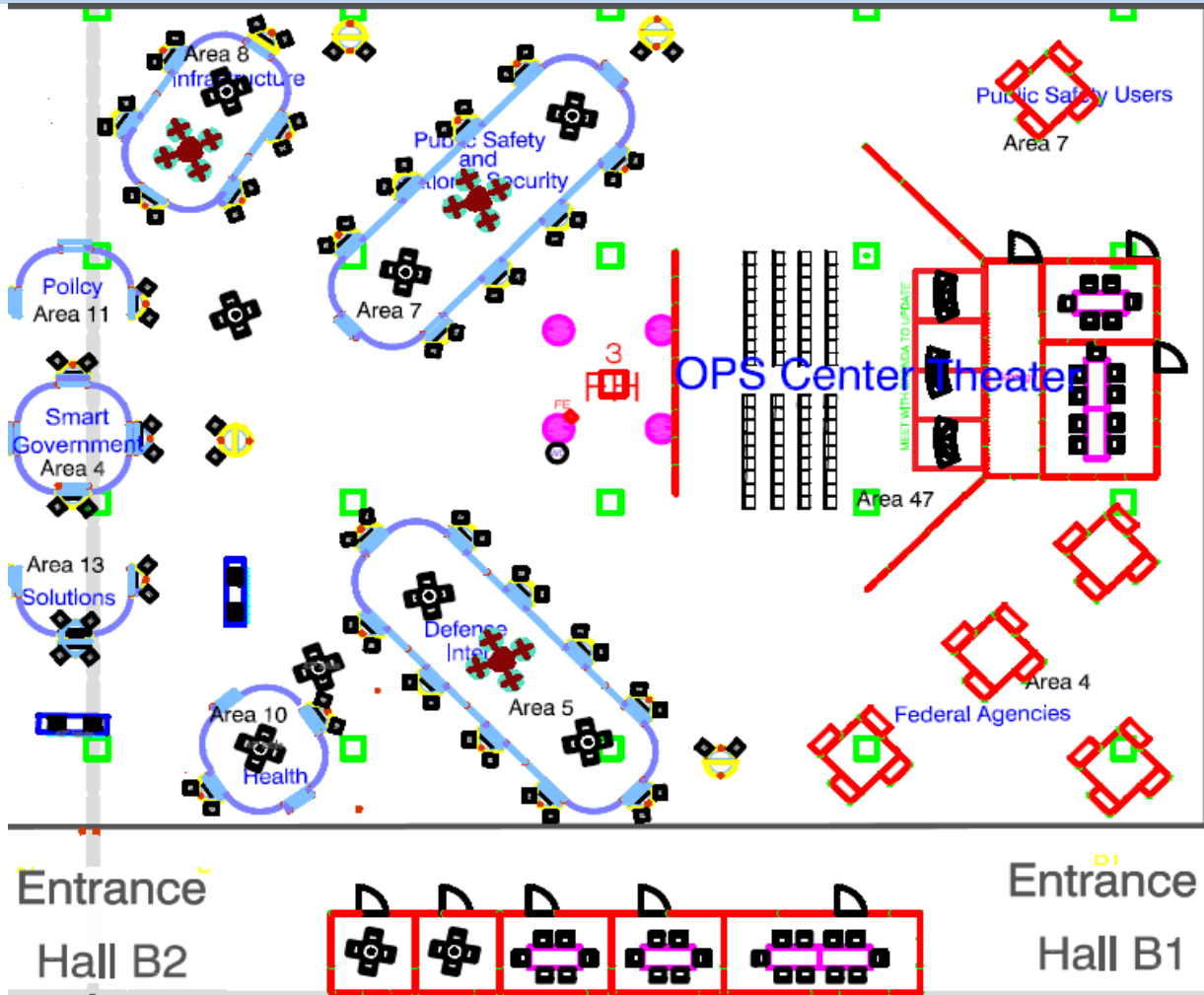

## OPS Center Demo Theater Schedule

Location: Public Safety and National Security Neighborhood, SDCC, Exhibit Hall B1

### Tuesday, June 28

9:30 AM	A Vision for Empowering Web GIS in National Security to Enable Safe Communities
11:30 AM	A Vision for Empowering Web GIS in Fire & Emergency Services to Enable Safe Communities
2:00 PM	A Vision for Empowering Web GIS in Emergency Management to Enable Safe Communities
4:00 PM	A Vision for Empowering Web GIS in Law Enforcement to Enable Safe Communities

### Wednesday, June 29

9:30 AM	Building Useful Information Products for Fire & Emergency Services Missions Using Web GIS
11:30 AM	Building Useful Information Products for National Security Missions Using Web GIS
2:00 PM	Building Useful Information Products for Emergency Management Missions Using Web GIS
4:00 PM	Building Useful Information Products for Law Enforcement Missions Using Web GIS

### Thursday, June 30

9:30 AM	Building Useful Information Products for Emergency Management Missions Using Web GIS
10:30 AM	Building Useful Information Products for Fire & Emergency Services Missions Using Web GIS
11:30 AM	Building Useful Information Products for Law Enforcement Missions Using Web GIS
12:30 PM	Building Useful Information Products for National Security Missions Using Web GIS



SDCC = San Diego Convention Center

Please note: Above entries are subject to change; not every paper or event may be listed here.

## Industry Focus Sessions and Technical Workshops

### Tuesday, June 28

8:30 AM	ArcGIS for Emergency Management: An Overview	SDCC, Room 16 A
3:15 PM	Fire Service Maps and Apps for Local Government	SDCC, Room 33 A

### Wednesday, June 29

10:15 AM	Law Enforcement Maps and Apps for Local Government	SDCC, Room 17 A
----------	--	-----------------

### Thursday, June 30

2:00 PM– 5:00 PM	Esri Public Safety Workshop: Preparing for and Supporting Special Events with ArcGIS Online	Marriott Marquis & Marina, Marina Ballroom—Salon F
---------------------	--	---

## Public Safety Demo Theater Schedule

*Location: SDCC, Exhibit Hall B1, Theater #13 (along the back wall of the EXPO)*

### Tuesday, June 28

9:30 AM	Esri's Experience in Using ArcGIS to Manage Special Events
10:30 AM	Introduction to Fire Incident Maps
11:30 AM	Solutions for Flood Management and Preparation
12:30 PM	An Overview of the Situational Awareness Solution
1:30 PM	Configuring the Situational Awareness Solution
2:30 PM	Launching the ArcGIS Platform for Law Enforcement
3:30 PM	Launching the ArcGIS Platform for the Fire Service
4:30 PM	Esri Disaster Response Program Overview and Highlighting Recent Events
5:30 PM	Not Your Chief's GIS—ArcGIS in Today's Law Enforcement

### Wednesday, June 29

9:30 AM	Using ArcGIS GeoEvent Extension for Server to Process Real-Time Weather Feeds
10:30 AM	South Carolina Flooding Response
11:30 AM	Configuring the Operations Dashboard for Situational Awareness
12:30 PM	Configuring the Damage Assessment Solution for Your Community
1:30 PM	Create Effective Briefings Using the Esri Story Map Journal
2:30 PM	Improving Police Legitimacy, Building Public Trust, and Engaging Citizens with the ArcGIS Platform
3:30 PM	Launching the ArcGIS Platform for Emergency Management
4:30 PM	Special Events Planning with ArcGIS
5:30 PM	Pre-Incident Planning with ArcGIS

### Thursday, June 30

9:30 AM	Workforce for ArcGIS: Applications for Law Enforcement Agencies
10:30 AM	ArcGIS Full-Motion Video Capabilities for Public Safety
11:30 AM	Introduction to Hazard Mitigation
12:30 PM	Configuring Fire Run Books and Station Wall Maps for Your Fire Department

## Envisioning Center East Demo Theater

*Location: SDCC, Exhibit Hall B2*

### Wednesday, June 29

11:30 AM	National Security—Making Smart Communities Safer And More Resilient
----------	---

## Special Interest Group (SIG) Meetings

### Tuesday, June 28

NOON	National Security SIG Meeting	SDCC, Room 28 C
NOON	Emergency Call-Taking and Dispatch SIG Meeting	SDCC, Room 26 A

### Wednesday, June 29

NOON	Law Enforcement SIG Meeting	SDCC, Room 28 C
NOON	Wildland Fire SIG Meeting	SDCC, Room 30 C

### Thursday, June 30

NOON	Disaster / Emergency Management SIG Meeting	SDCC, Room 30 D
------	---	-----------------



## Moderated Paper Presentations

### Tuesday, June 28

8:30 AM	Public Safety	Emergency Call Taking and Dispatch Using GIS	SDCC, Room 26 A
10:15 AM	Public Safety	GIS for Next-Generation E911	SDCC, Room 26 B
10:15 AM	Disaster Management	Risk and Vulnerability Analysis Using GIS	SDCC, Room 30 D
1:30 PM	Disaster Management	GIS for Disaster Planning and Mitigation	SDCC, Room 30 D
1:30 PM	National Security	GIS for Homeland and National Security	SDCC, Room 28 C
3:15 PM	Disaster Management	Regional Collaboration for Emergency Management	SDCC, Room 30 D

### Wednesday, June 29

8:30 AM	Disaster Management	Getting People Out of Harm's Way	SDCC, Room 30 D
8:30 AM	Public Safety	GIS for Emergency Response	SDCC, Room 30 C
10:15 AM	Disaster Management	GIS for Flood Management	SDCC, Room 30 D
10:15 AM	Public Safety	GIS for Wildfire Risk Assessment	SDCC, Room 30 C
1:30 PM	Disaster Management	GIS for Severe Weather Emergencies	SDCC, Room 30 D
1:30 PM	Law Enforcement	GIS for Mission-Critical Intelligence	SDCC, Room 28 C
1:30 PM	Public Safety	GIS for Managing Wildfire Information	SDCC, Room 30 C
3:15 PM	Disaster Management	GIS Data Collection for Disaster Management	SDCC, Room 30 D
3:15 PM	Law Enforcement	GIS for Crime Analysis	SDCC, Room 28 C
3:15 PM	Public Safety	GIS for Wildland Fire Management	SDCC, Room 30 C

### Thursday, June 30

8:30 AM	Disaster Management	GIS for Hazmat and Spill Response	SDCC, Room 30 D
10:15 AM	Disaster Management	Earthquake and Landslide Management with GIS	SDCC, Room 30 D
10:15 AM	Public Safety	Pre-Incident Planning with GIS	SDCC, Room 30 C
1:30 PM	Disaster Management	GIS for Disaster Management	SDCC, Room 30 D
3:15 PM	Disaster Management	GIS for Emergency Management Practices	SDCC, Room 30 D

## Thank You To Our Sponsors

### User Conference Elite Sponsors



### National Security and Public Safety Social Sponsors

### National Security and Public Safety Summit Social/EXPO Sponsor

### Special Interest Group Meeting Sponsor



## Stay Connected

- Follow GIS Public Safety on Twitter at <https://twitter.com/GISPublicSafety>
- Join Esri—GIS Public Safety on Facebook at <https://www.facebook.com/GISPublicSafety/>
- Follow EsriDRP on Twitter at <https://twitter.com/EsriDRP>
- Join Esri—Disaster Response Program on Facebook at <https://www.facebook.com/DRP365/>
- Join Esri Public Safety on LinkedIn Groups at <https://www.linkedin.com/groups/7049336>
- Join the conversation on the Public Safety GeoNet Community at <https://geonet.esri.com/community/public-safety>

For more information on public safety and national security visit [www.esri.com/safecommunities](http://www.esri.com/safecommunities) or [www.esri.com/publicsafety](http://www.esri.com/publicsafety).



SDCC = San Diego Convention Center

Please note: Above entries are subject to change; not every paper or event may be listed here.