



COVID-19: GET LIVE MAPS, DATA, & INFO

Esri COVID-19 Newsletter | May 27, 2020



Dear User,

This is the seventh email in our weekly newsletter series. This week's issue features resources to support reopening. Here you will find highlighted webinars and training addressing COVID-19, news spotlights, and other related resources. If you've missed any of the previous editions of this newsletter, you can access them in the archive on [GeoNet](#).

As we move through this pandemic, looking back at our favorite places can also be a way to look forward. Join the GIS community as we share maps and memories of all the destinations we can't visit during these times—together, we can create hope as we look ahead to a future where we can visit our favorite places once again. Explore the [#TakeMeBack collection](#).

RESOURCES

COVID-19 GIS Resources

We continue to encourage you to visit the GIS Hub often. This resource is updated daily with new information as it becomes available from Esri, our business partners, and our geographic information system (GIS) community around the world.

What's Coming Soon...

- Additional enhancements for business continuity in reopening
- More information on leveraging the Storyteller User Type

Esri is continuing to develop resources to support your reopening needs. We want to hear from you. Please share your ideas and requirements on what you'd like to see next via our community forum on [GeoNet](#).

Click the link below to get access to the latest maps, datasets, applications, and more for COVID-19 to help you visualize and analyze the pandemic in the context of your community or organization.

[Access Now](#)

FEATURED IN THIS ISSUE

Video: Modeling COVID-19 in ArcGIS

In this video explore different reopening scenarios utilizing the COVID-19 Modeling Toolbox, including its uses within the ArcGIS community and the new COVID-19 Surge (CDC) tool that was added.

[Watch Now](#)

COVID-19 Trends Maps for US Counties

This interactive map uses county-level data from Johns Hopkins University to visualize the day-to-day rate of new cases across the United States. Explore multiple data layers that show transmission trends, mortality rates, recent outbreaks, active cases, and more.

[Explore Now](#)

COVID-19 Sample Surveys for Survey123

This practical blog on GeoNet shares COVID-19 survey templates for use in Survey123 and discusses best practices for utilizing these examples in your own community or organization.

[Read More](#)

Story Map: Social Vulnerability and COVID-19

Coronavirus affects different groups with varying levels of severity. Which areas in the US are at greater risk of bearing the burden of this virus? Learn more about the social vulnerability indicators and the methodology behind them through engaging infographics.

[Read More](#)

Epidemiology and ArcGIS Insights - Part 2

This is Part 2 of a two-part blog exploring the scope of epidemiology, how GIS provides an important analytical component, and what ArcGIS Insights can do to support epidemiological analysis.

[Read More](#)

WEBINARS & TRAINING

Tutorial: Analyzing Health Data with ArcGIS Pro

Learn how to easily combine age and vulnerability data into a single layer utilizing ArcGIS Pro. This tutorial walks through the creation of a story map about age and social vulnerability in the context of COVID-19.

[Learn More](#)



Business Risks and Disruptions

May 28 | 12:00 p.m. (PDT)

This webinar will cover how to identify and assess risks globally, regionally, or hyper-locally, examine the impact of the crisis on operations, and mitigate disruptions.

[Register Now](#)



City of New Haven's Five Lessons

June 24 | 10 a.m. (PDT)

Join the City of New Haven, Connecticut in this upcoming webinar as they discuss five lessons learned from the city's COVID-19 response efforts. Hear first-hand accounts of New Haven's pandemic response experiences and what lies ahead for the city in the future.

[Register Now](#)



Facility Mapping Solutions for COVID-19 Recovery

To reopen the workplace, managers will need to make decisions that ensure the workplace environment is safe and adheres to social distancing guidelines.

Learn about the solutions that can be used in a variety of indoor mapping scenarios to support these decisions.

[Read More](#)

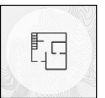

SOLUTIONS

Coronavirus Wellness Checks

This solution includes a series of ArcGIS applications that can be used by Public Health staff to engage community volunteers, register homebound individuals, conduct regular wellness checks, and monitor the wellness of vulnerable individuals.

[Access Now](#)

Blog: How to use the Coronavirus Wellness Checks Solution

The Centers for Disease Control (CDC) has indicated that people 65 years and older are at a higher risk for severe illness. Unfortunately, with social distancing in place, it can be challenging to determine the well-being at-risk individuals. Learn more on how to use the new Wellness Checks Solution to engage volunteers and extend the public health and safety workforce in this time of need.

[Read More](#)

Small Business Recovery

This solution supports Economic Development staff with small business operations by enabling them to engage with local business owners, measure the impact of the pandemic on small businesses, and report potential health order violations and their resolution.

[Access Now](#)

Blog: How to use the Small Business Recovery Solution

As states have started executing their coronavirus (COVID-19) reopening plans, many have included reopening phases that dictate which business sectors can resume operations as key metrics are met. This blog will show examples of how the new Small Business Recovery Solution can be used to promote coronavirus recovery programs.

[Read More](#)

CONNECT WITH YOUR GIS COMMUNITY

GeoNet is the place where Esri staff, partners, users, and others in the GIS community are connecting, collaborating, and sharing best practices to respond to COVID-19.

[Join the Conversation](#)



Subscribe to the newsletter. [Click Here](#)